

N12K2 Hadron FWD-lean Set
(= Lean-block + Lever + hardware)

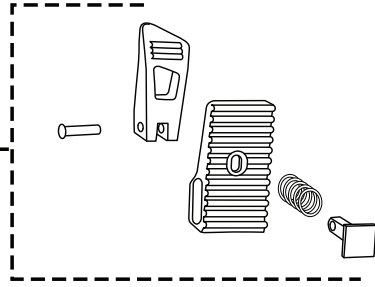

N2F2 Asym Hadron Hiback Set
(= Hiback + EVA-pad + FWD-lean assembled)

18F1 LSR Pivot Ankle-ladder

N28F1 Axis.N1 C-bolt Set
(= Screw M5*22 + Pivot-Washer + T-nut)

N1F1 Axis.N1-Series Muon Baseplate+Heelcup

18A1 LSR Toe-ladder w/ plug

21H2 Multi-Disk Mounting disk w/ screws (M6*14.5)

Axion Ankle-ratchet w/ screw

N41K1

Ankle ComfortFit-strap w/ QS-latch

N11A1

QuickSet Ankle-ladder

17G1

Axion Toe-ratchet w/ screw

N41L1

Hexo Toecap w/ QS-latch

11A2

QuickSet Toe-ladder w/ plug

N17D1

Axis-NXS Baseplate-Cushioning set
(= Heel-EVA + Rocker-EVA)

08C1

Mounting screws (M6*14.5)

42G1

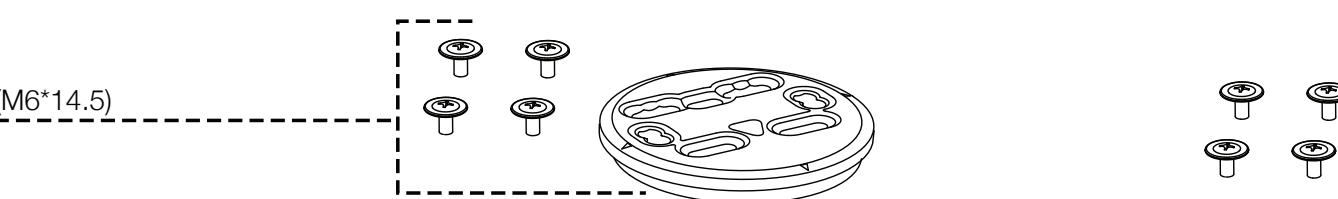

NIDECKER — CLASSICS BINDINGS

FOR KAON-X, KAON-W, MUON-X, MUON-W & PRIME



Thank you for purchasing Nidecker bindings. We recommend that your bindings be mounted and maintained by a trained, professional mechanic.

Tools needed:
Screwdriver



PH#3

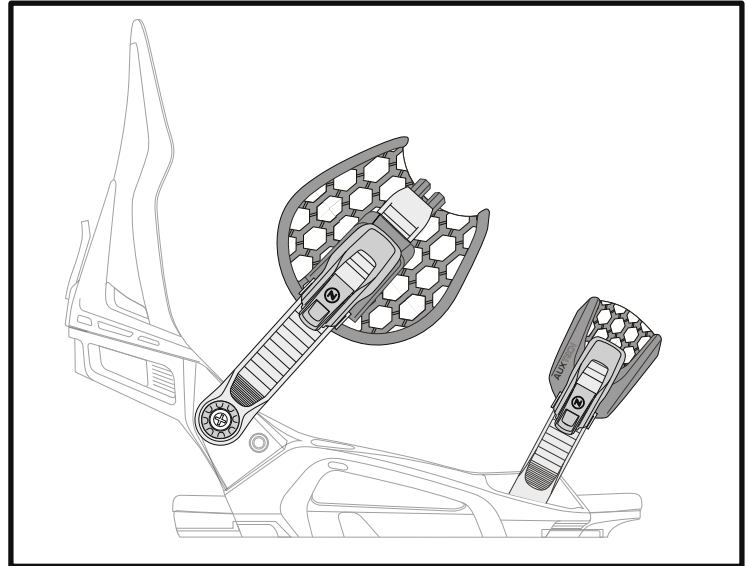

All Nidecker bindings can be fully personalized for a superior fit to your boot and riding style. Please go to www.NIDECKER.com for videos, details and tricks & tips for each of our models.

BUCKLE REPLACEMENT

On topside, attach buckle with supplied screw into spiked T-nut, using Philips #2 screwdriver.

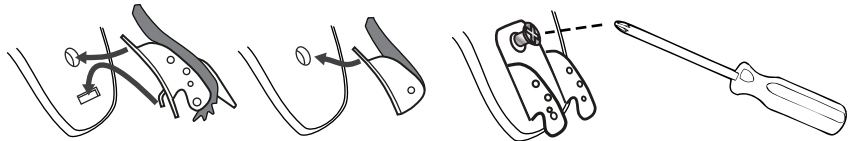

CHANGE YOUR LADDERSTRAP

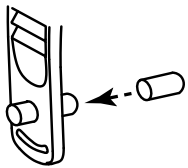

Use ladderstraps with this bottom shape and attachment pins. Insert ladderstraps from top into the slots, add stopper pins into ladders from bottom.

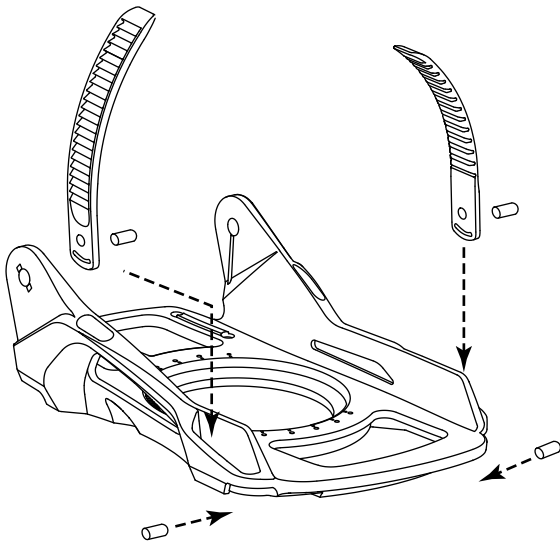

CHANGE YOUR HIBACK

Remove the two outer screws on the top straps.

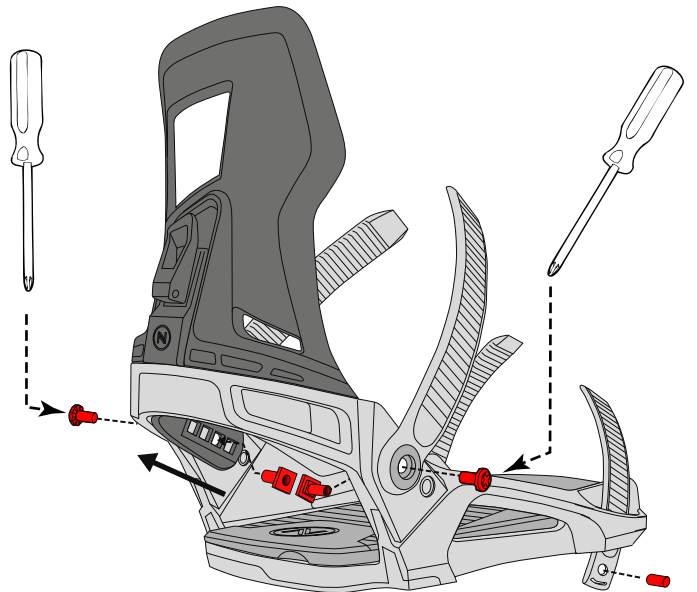

IMPORTANT NOTE: Be sure that all parts are assembled correctly and secure, failure to do so may cause serious injuries. Nidecker recommends that any and all service and repairs to your bindings be done by a trained, professional mechanic. For our full liability policy, how-to tricks and tips and more, please visit WWW.NIDECKER.COM

